

To perform this installation you will need:

- Socket Wrench with 1/2" Socket

- 1/2" Wrench

- Utility Knife

- Drill with 11/32" bit

- Clip removal tool

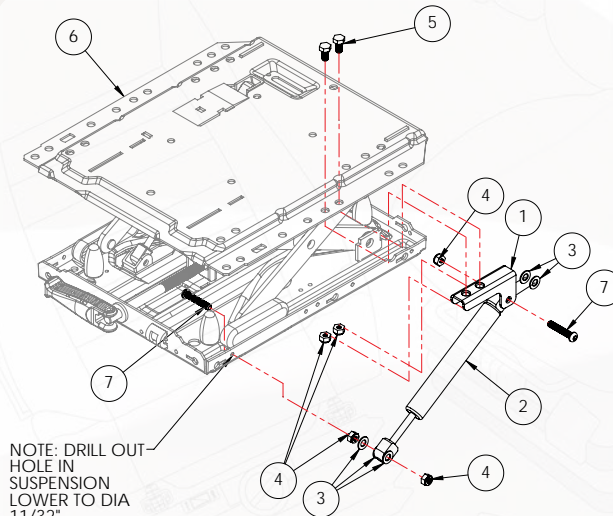

NOTE: DRILL OUT HOLE IN SUSPENSION LOWER TO DIA 11/32"

ITEM NO.	PART NUMBER	DESCRIPTION	QTY.
1	330-260	DAMPER BRACKET	1
2	870-300	DAMPER	1
3	200-264	WASHER	5
4	200-216	NUT	5
5	200-156	15MM M8 BOLT	2
6	N/A	S032 SUSPENSION	N/A
7	200-151	M8 X 40MM BUTTON HEAD BOLT	2

UPDATED: 14/03/19

S032 ADDITIONAL DAMPER INSTALLATION GUIDE



ULTRA
ULTRA SEAT CORPORATION

S032 Damper Kit parts and hardware included for installation.

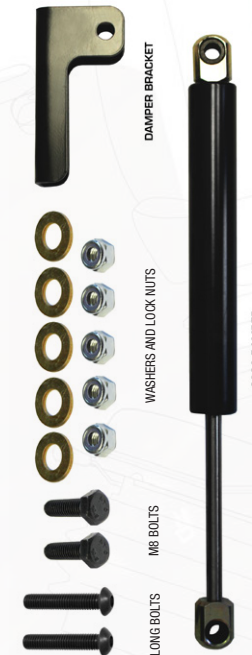

15001105

1 While facing the suspension, cut a 2" long access slot in the bottom left corner of the suspension boot on the right hand side . Again, make sure you are facing the front of the suspension. This will allow you to pull the damper shaft through the boot to mount to the lower part of the suspension.



2 Undo clips on bottom right side of suspension boot and save them for Step 9. Roll-up the boot to have access to the underside of the suspension top plate.

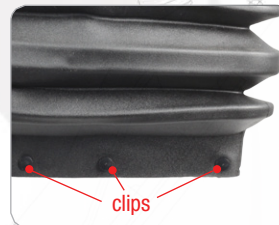

3 Lift suspension boot in same corner as in Step 1 and drill to widen the existing hole to 11/32" diameter. It's the first hole back from the front of the suspension.



4 Align the top of the supplied bracket with the underside of holes 5 and 6 on the top plate on the right hand side of the suspension, when facing the front of the suspension. Mount using 2 M8 bolts and 2 lock nuts provided.



5 To install the cylinder side of the damper to the bracket you will use 1 long bolt, 2 washers and 1 lock nut.

Start by placing a washer inside the bracket and against the first hole. Insert the long bolt just enough to hold the washer in place. Next, slide the cylinder side of the damper in place and insert the bolt just enough to hold it in place. Now take the second washer and slide it between the damper and bracket then insert the bolt all the way through and secure with the lock nut. Your assembly should look like the following picture when complete.



6 Place the damper inside the suspension boot and pull the damper shaft through the slot you cut in Step 1.



7 To mount the damper shaft into the suspension base start by inserting a long bolt into the hole you widened in Step 2, secured the bolt on the outside with a lock nut.



8 Mount the damper shaft to the suspension base in the following order: place 2 washers (as spacers), insert the damper shaft, slide another washer and secure with the last lock nut. When finished, it should look like the following picture.



9 Re-attach the bottom right side of suspension boot to the base using clips.



Completed Installation without Boot



Completed Installation with Boot

Please visit www.ultraseat.com for more information regarding this product.

S032 ADDITIONAL DAMPER INSTALLATION GUIDE